

# LAKE MILLS SITE

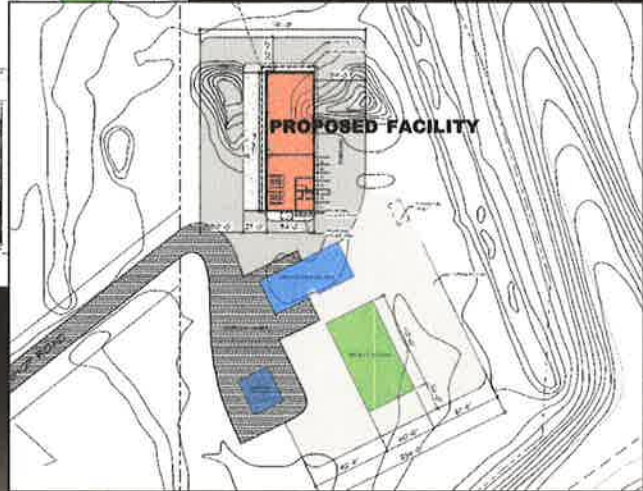

# CONCORD SITE

# FACILITY PLAN – BID #1

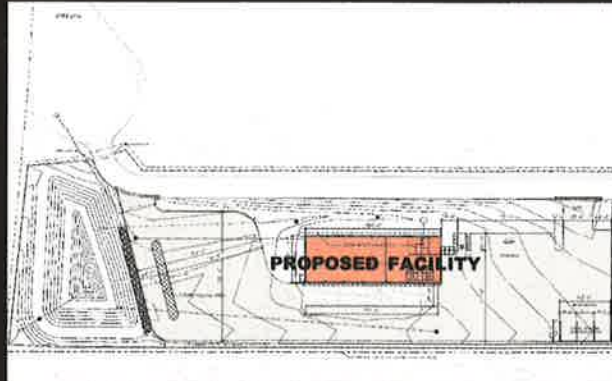
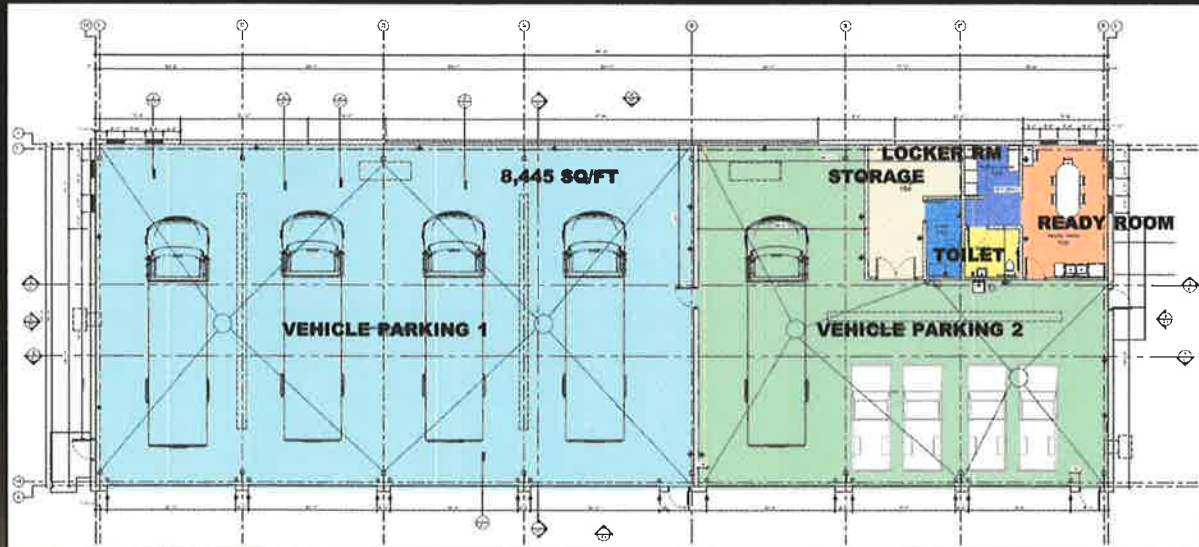

# BID RESULTS

Bid Date - April 21, 2016

Jefferson County - Highway Satellite Facilities

General Contractor	Water Bid #1, Lake Mills	Water Bid #2, Concord Site	Water Bid #3, Irons Station	Geothermal Heating, 2nd cooling system	Asphalt paving for the Lake Mills site	Asphalt paving for the Concord site	Lake Price 1A	Lake Price 2B	Lake Price 1-C	Site Work	# Days	ASAP	ASAP	ASAP	ASAP
Briani Brother	\$1,920,000	\$1,185,000	\$2,870,000	\$72,617	\$118,288	\$61,000	\$3	\$3	\$430	Y	118	X	X	X	X
Harmony Construction	\$1,418,241	\$1,088,824	\$2,490,049	\$148,918	\$117,790	\$61,787	\$32.40	\$32.40	\$488	Y	115	X	X	X	X
KW Construction	\$1,880,039	\$969,412	\$2,110,222	\$171,779	\$118,989	\$67,892	\$8.90	\$22	\$590	Y	105	X	X	X	X
Maj III Construction	\$1,923,000	\$1,024,000	\$2,326,000	\$181,288	\$113,692	\$60,018	\$30	\$30	\$393	Y	110	X	X	X	X
Abbaslate Construction	\$1,275,000	\$1,017,000	\$2,266,000	\$160,000	\$140,000	\$70,000	\$30	\$40	\$750	Y	110	X	X	X	X
J.H. Messinger	\$1,490,000	\$1,103,000	\$2,193,000	\$190,000	\$118,000	\$68,000	\$38	\$38	\$360	Y	110	X	X	X	X
Cardinal Construction	\$1,303,192	\$953,338	\$2,264,435	\$178,000	\$117,790	\$61,787	\$31	\$32	\$664	Y	110	X	X	X	X
Vogel Brothers	\$1,423,000	\$1,097,000	\$2,420,000	\$181,600	\$122,787	\$60,200	\$40	\$24	\$1,000	Y	110	X	X	X	X
Advanced Building Concepts	\$1,273,200	\$1,028,900	\$2,192,800	\$200,000	\$133,800	\$69,200	\$20	\$20	\$400	Y	110	X	X	X	X

### BID RESULTS

- LAKE MILLS \$1,180,029
- CONCORD \$969,412
- TOTAL \$2,130,222

### GEOTHERMAL

- LOW BID \$79,675
- HIGH BID \$200,000

# FACILITY PLAN – BID #2

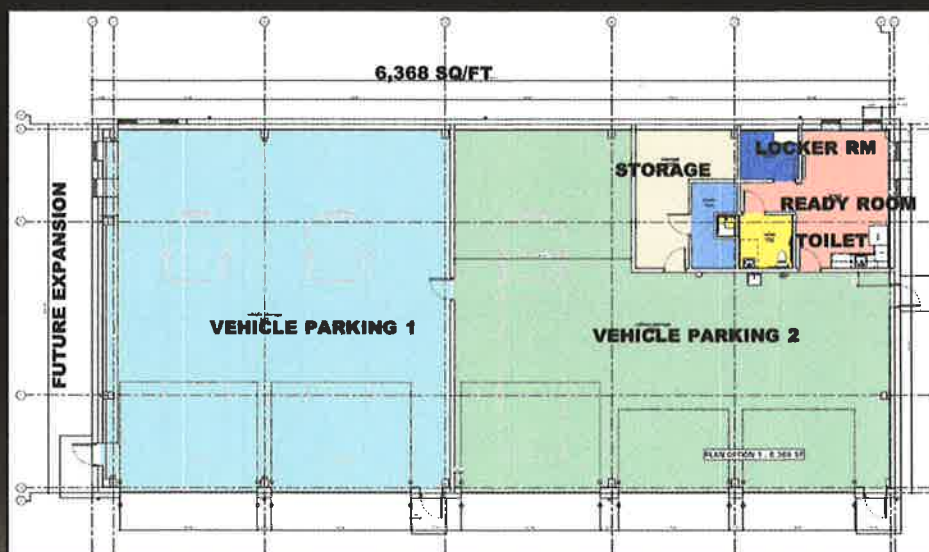

### CHANGES

- 8,445 SQ/FT TO 6,368 SQ/FT
- 5 LARGE STALLS TO 3
- 4 SMALL STALLS TO REMAIN

### BID ALTERNATES

- POLE BUILDING DESIGN
- COMPLETE PRE-ENG
- MASONRY KNEE WALL

### ITEMS TO BE COMPLETED BY THE COUNTY

- SITE GRADING
- SITE UTILITIES
- SITE ASPHALT

COUNTY HAS COST CONTROL ON THE SITE RELATED SCOPES



**Satellite Facility  
Jefferson County**



**KUENY**  
**ARCHITECTS**

**QUESTIONS**  
**?**